

This package contains **Mason ProNet™**
 100 LF of 1" or 2" Mason ProNet™ or 250 LF of Mason ProNet™

General Information

1. Fast and easy to use - no fasteners or adhesives, no special skills or tools. After the first one to two courses of bricks are laid, place a continuous row of *Mason ProNet™* in cavity or collar joint on flashing (**trapezoidal side up**) against inside of outer wythe at base of wall (**see diagram**).
2. Install Mason ProNet™ **directly on flashing** at base of wall, over all wall openings, shelf angles, sills or lentils.
3. Install Mason ProNet™ at every floor level. For wall-cavities that exceed 11' in height, place an additional continuous trapezoidal strip on wall reinforcing anchors/ties at every 9' to 11' of wall height.
4. Flashing should extend from bottom to 6" above the top of Mason ProNet™, as should any other materials used to fill space between Mason ProNet™ and inside cavity surface.
5. If 1" or 2"-thick Mason ProNet™ is used, no more than 1/4" should be left between Mason ProNet™ and cavity's inside surface (flashing or filler). 0.4"-thick Mason ProNet™ should touch both cavity surfaces, or can be used as additional filler with other widths of Mason ProNet™ - **trapezoidal side up and aligned with each other**. Mason ProNet™ is compressible to allow for variations in wall-cavity widths.

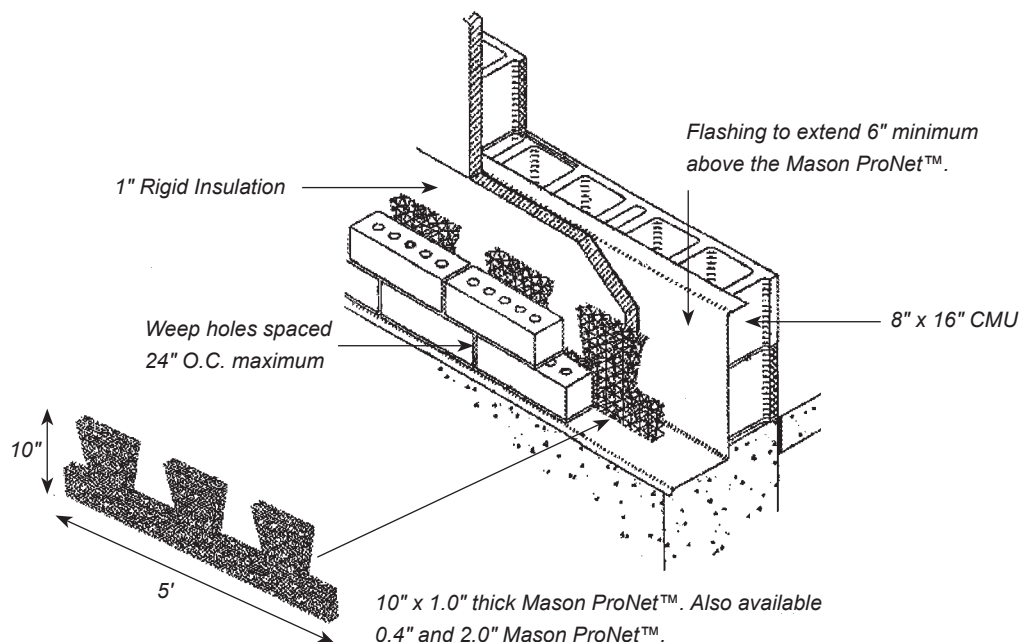
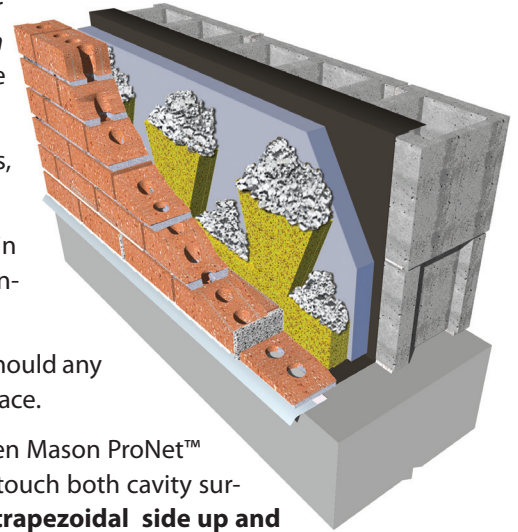

Mason ProNet™ should be installed only by experienced masons in properly specified weep hole/flashing systems.

For Technical Support or to Report Defective Product: Please Call 1-800-659-4731