

## BITUTHENE® SYSTEM 4000

Self-adhesive HDPE waterproofing membrane with super tacky compound for use with patented, water-based System 4000 Surface Conditioner

### Description

Bituthene® System 4000 is a 1.5 mm (1/16 in.) flexible, pre-formed waterproof membrane which combines a high performance, cross laminated, HDPE carrier film with a unique, super tacky, self-adhesive rubberized asphalt compound.

System 4000 Surface Conditioner is a unique, water-based, latex surface treatment which imparts an aggressive, high tack finish to the treated substrate. It is specifically formulated to bind site dust and concrete efflorescence, thereby providing a suitable surface for the Bituthene System 4000 Waterproofing Membrane.

Conveniently packaged in each roll of membrane, System 4000 Surface Conditioner promotes good initial adhesion and, more importantly, excellent permanent adhesion of the Bituthene System 4000 Waterproofing Membrane. The VOC (Volatile Organic Compound) content of this product is 100 g/L.

Architectural and Industrial Maintenance Regulations limit the VOC content in products classified as Architectural Coatings. Refer to Technical Letters at [graceconstruction.com](http://graceconstruction.com) for most current list of allowable limits.

### Advantages

- **Excellent adhesion**—special adhesive compound engineered to work with high tack System 4000 Surface Conditioner
- **Cold applied**—simple application to substrates, especially at low temperatures
- **Reduced inventory and handling costs**—System 4000 Surface Conditioner is included with each roll of membrane
- **Wide application temperature range**—excellent bond to self and substrate from 25°F (-4°C) and above

### Product Advantages

- Excellent adhesion
- Cold applied
- Reduced inventory and handling costs
- Wide application temperature range
- Overlap security
- Cross laminated, high density polyethylene carrier film
- Flexible
- Ripcord

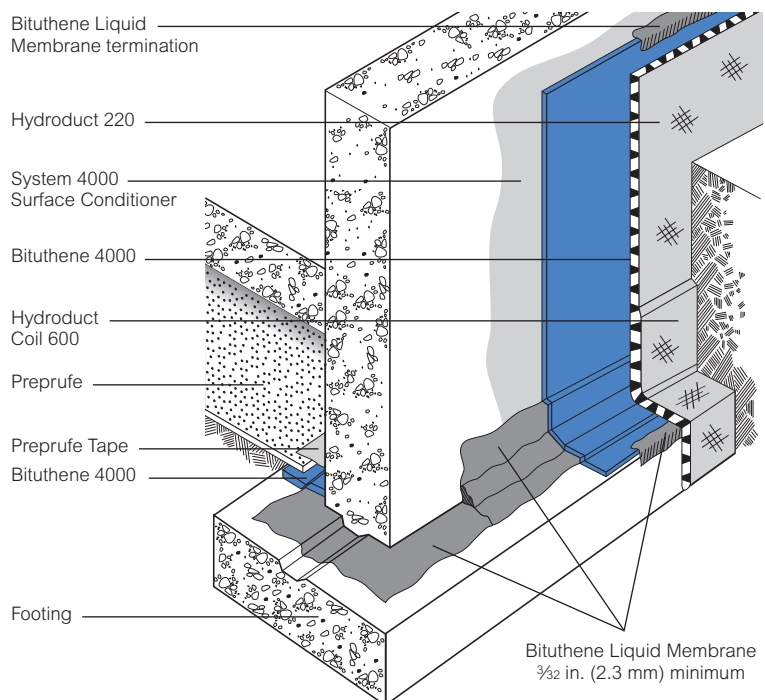

Drawings are for illustration purposes only. Please refer to [graceconstruction.com](http://graceconstruction.com) for specific application details.

- **Overlap security**—minimizes margin for error under site conditions
- **Cross laminated, high density polyethylene carrier film**—provides high tear strength, puncture and impact resistance
- **Flexible**—accommodates minor structural movements and will bridge shrinkage cracks
- **Ripcord**<sup>®</sup>—this split release on demand feature allows the splitting of the release paper into two (2) pieces for ease of installation in detailed areas

## Use

Bituthene is ideal for waterproofing concrete, masonry and wood surfaces where in-service temperatures will not exceed 135°F (57°C). It can be applied to foundation walls, tunnels, earth sheltered structures and split slab construction, both above and below grade. (For above grade applications, see *Above Grade Waterproofing Bituthene System 4000*.)

Bituthene is 1/16 in. (1.5 mm) thick, 3 ft (0.9 m) wide and 66.7 ft (20 m) long and is supplied in rolls. It is unrolled sticky side down onto concrete slabs or applied onto vertical concrete faces primed with System 4000 Surface Conditioner. Continuity is achieved by overlapping a minimum 2 in. (50 mm) and firmly rolling the joint.

Bituthene is extremely flexible. It is capable of bridging shrinkage cracks in the concrete and will accommodate minor differential movement throughout the service life of the structure.

## Application Procedures

### Safety, Storage and Handling Information

Bituthene products must be handled properly. Vapors from solvent-based primers and mastic are harmful and flammable. For these products, the best available information on safe handling, storage, personal protection, health and environmental considerations has been gathered. Material Safety Data Sheets (MSDS) are available at [graceconstruction.com](http://graceconstruction.com) and users should acquaint themselves with this information. Carefully read detailed precaution statements on product labels and the MSDS before use.

## Surface Preparation

Surfaces should be structurally sound and free of voids, spalled areas, loose aggregate and sharp protrusions. Remove contaminants such as grease, oil and wax from exposed surfaces. Remove dust, dirt, loose stone and debris. Concrete must be properly dried (minimum 7 days for normal structural concrete and 14 days for lightweight structural concrete).

**If time is critical, Bituthene Primer B2 or Bituthene Primer B2 LVC may be used to allow priming and installation of membrane on damp surfaces or green concrete. Priming may begin in this case as soon as the concrete will maintain structural integrity.** Use form release agents which will not transfer to the concrete. Remove forms as soon as possible from below horizontal slabs to prevent entrapment of excess moisture. Excess moisture may lead to blistering of the membrane. Cure concrete with clear, resin-based curing compounds which do not contain oil, wax or pigment. Except with Bituthene Primer B2 or Bituthene Primer B2 LVC, allow concrete to thoroughly dry following rain. Do not apply any products to frozen concrete.

Repair defects such as spalled or poorly consolidated areas. Remove sharp protrusions and form match lines. On masonry surfaces, apply a parge coat to rough concrete block and brick walls or trowel cut mortar joints flush to the face of the concrete blocks.

## Temperature

- Apply Bituthene System 4000 Membrane and Conditioner only in dry weather and when air and surface temperatures are 25°F (-4°C) or above.
- Apply Bituthene Primer B2 or Bituthene Primer B2 LVC in dry weather above 25°F (-4°C). (See separate product information sheet.)

## Conditioning

Bituthene System 4000 Surface Conditioner is ready to use and can be applied by spray or roller. For best results, use a pump-type air sprayer with fan tip nozzle, like the Bituthene System 4000 Surface Conditioner Sprayer, to apply the surface conditioner.

Apply Bituthene System 4000 Surface Conditioner to clean, dry, frost-free surfaces at a coverage rate of 300 ft<sup>2</sup>/gal (7.4 m<sup>2</sup>/L). Coverage should be uniform. Surface conditioner should not be applied so heavily that it puddles or runs. **Do not apply conditioner to Bituthene membrane.**

Allow Bituthene System 4000 Surface Conditioner to dry one hour or until substrate returns to its original color. At low temperatures or in high humidity conditions, dry time may be longer.

Bituthene System 4000 Surface Conditioner is clear when dry and may be slightly tacky. In general, conditioning should be limited to what can be covered within 24 hours. In situations where long dry times may prevail, substrates may be conditioned in advance. Substrates should be reconditioned if significant dirt or dust accumulates.

Before surface conditioner dries, tools should be cleaned with water. After surface conditioner dries, tools should be cleaned with mineral spirits. Mineral spirits is a combustible liquid which should be used only in accordance with manufacturer's recommendations. **Do not use solvents to clean hands or skin.**

### Corner Details

The treatment of corners varies depending on the location of the corner. For detailed information on Bituthene Liquid Membrane, see separate product information sheet.

- At wall to footing inside corners—  
**Option 1:** Apply membrane to within 1 in. (25 mm) of base of wall. Treat the inside corner by installing a ¾ in. (20 mm) fillet of Bituthene Liquid Membrane. Extend Bituthene Liquid Membrane at least 2½ in. (65 mm) onto footing, and 2½ in. (65 mm) onto wall membrane.  
**Option 2:** Treat the inside corner by installing a ¾ in. (20 mm) fillet of Bituthene Liquid Membrane. Apply 12 in. (300 mm) wide strip of sheet membrane centered over fillet. Apply wall membrane over inside corner and extend 6 in. (150 mm) onto footing. Apply 1 in. (25 mm) wide troweling of Bituthene Liquid Membrane over all terminations and seams within 12 in. (300 mm) of corner.

- At footings where the elevation of the floor slab is 6 in. (150 mm) or more above the footing, treat the inside corner either by the above two methods or terminate the membrane at the base of the wall. Seal the termination with Bituthene Liquid Membrane.

### Joints

Properly seal all joints with waterstop, joint filler and sealant as required. Bituthene membranes are not intended to function as the primary joint seal. Allow sealants to fully cure. Pre-strip all slab and wall cracks over ¼ in. (1.5 mm) wide and all construction and control joints with 9 in. (230 mm) wide sheet membrane strip.

### Application on Horizontal Surfaces

(Note: Preprufe® pre-applied membranes are strongly recommended for below slab or for any application where the membrane is applied before concreting. See Preprufe product information sheets.)

Apply membrane from the low point to the high point so that laps shed water. Overlap all seams at least 2 in. (50 mm). Stagger all end laps. Roll the entire membrane firmly and completely as soon as possible. Use a linoleum roller or standard water-filled garden roller less than 30 in. (760 mm) wide, weighing a minimum of 75 lbs (34 kg) when filled. Cover the face of the roller with a resilient material such as a ½ in. (13 mm) plastic foam or two wraps of indoor-outdoor carpet to allow the membrane to fully contact the primed substrate. Seal all T-joints and membrane terminations with Bituthene Liquid Membrane at the end of the day.

### Protrusions and Drains

Apply membrane to within 1 in. (25 mm) of the base of the protrusion. Apply Bituthene Liquid Membrane 0.1 in. (2.5 mm) thick around protrusion. Bituthene Liquid Membrane should extend over the membrane a minimum of 2½ in. (65 mm) and up the penetration to just below the finished height of the wearing course.

### Vertical Surfaces

Apply membrane in lengths up to 8 ft (2.5 m). Overlap all seams at least 2 in. (50 mm). On higher walls apply membrane in two or more sections with the upper overlapping the lower by at least 2 in. (50 mm). Roll all membrane with a hand roller.

Terminate the membrane at grade level. Press the membrane firmly to the wall with the butt end of a hardwood tool such as a hammer handle or secure into a reglet. Failure to use heavy pressure at terminations can result in a poor seal. A termination bar may be used to ensure a tight seal. Terminate the membrane at the base of the wall if the bottom of the interior floor slab is at least 6 in. (150 mm) above the footing. Otherwise, use appropriate inside corner detail where the wall and footing meet.

### Membrane Repairs

Patch tears and inadequately lapped seams with membrane. Clean membrane with a damp cloth and dry. Slit fishmouths and repair with a patch extending 6 in. (150 mm) in all directions from the slit and seal edges of the patch with Bituthene Liquid Membrane. Inspect the membrane thoroughly before covering and make any repairs.

## Drainage

Hydroduct® drainage composites are recommended for both active drainage and protection of the membrane. See Hydroduct product information sheets.

## Protection of Membrane

Protect Bituthene membranes to avoid damage from other trades, construction materials or backfill. Place protection immediately in temperatures above 77°F (25°C) to avoid potential for blisters.

- On vertical applications, use Hydroduct 220 Drainage Composite. Adhere Hydroduct 220 Drainage Composite to membrane with Hydroduct Tape. Alternative methods of protection are to use 1 in. (25 mm) expanded polystyrene or ¼ in. (6 mm) extruded polystyrene that has a minimum compressive strength of 8 lbs/in.<sup>2</sup> (55 kN/m<sup>2</sup>). Such alternatives do not provide positive drainage to

## System 4000 Surface Conditioner Sprayer

The Bituthene System 4000 Surface Conditioner Sprayer is a professional grade, polyethylene, pump-type, compressed air sprayer with a brass fan tip nozzle. It has a 2 gal (7.6 L) capacity. The nozzle orifice and spray pattern have been specifically engineered for the optimum application of Bituthene System 4000 Surface Conditioner.

Hold nozzle 18 in. (450 mm) from substrate and squeeze handle to spray. Spray in a sweeping motion until substrate is uniformly covered.

Sprayer should be repressurized by pumping as needed. For best results, sprayer should be maintained at high pressure during spraying.

To release pressure, invert the sprayer and spray until all compressed air is released.



### Maintenance

The Bituthene System 4000 Surface Conditioner Sprayer should perform without trouble for an extended period if maintained properly.

Sprayer should not be used to store Bituthene System 4000 Surface Conditioner. The sprayer should be flushed with clean water immediately after spraying. For breaks in the spray operation of one hour or less, invert the sprayer and squeeze the spray handle until only air comes from the nozzle. This will avoid clogging.

Should the sprayer need repairs or parts, call the maintenance telephone number on the sprayer tank (800-323-0620).

the system. If ¼ in. (6 mm) extruded polystyrene protection board is used, backfill should not contain sharp rock or aggregate over 2 in. (50 mm) in diameter. Adhere polystyrene protection board with Hydroduct Tape.

- In mud slab waterproofing, or other applications where positive drainage is not desired and where reinforced concrete slabs are placed over the membrane, the use of ¼ in. (6 mm) hardboard or 2 layers of ⅛ in. (3 mm) hardboard is recommended.

## Insulation

Always apply Bituthene membrane directly to primed or conditioned structural substrates. Insulation, if used, must be applied over the membrane. Do not apply Bituthene membranes over lightweight insulating concrete.

## Backfill

Place backfill as soon as possible. Use care during backfill operation to avoid damage to the waterproofing system. Follow generally accepted practices for backfilling and compaction. Backfill should be added and compacted in 6 in. (150 mm) to 12 in. (300 mm) lifts.

For areas which cannot be fully compacted, a termination bar is recommended across the top termination of the membrane.

## Placing Steel

When placing steel over properly protected membrane, use concrete bar supports (dobies) or chairs with plastic tips or rolled feet to prevent damage from sharp edges. Use special care when using wire mesh, especially if the mesh is curled.

## Approvals

- City of Los Angeles Research Report RR 24386
- Miami-Dade County Code Report NOA 04-0114.03
- U.S. Department of Housing and Urban Development (HUD) HUD Materials Release 628E
- Bituthene 4000 Membranes carry a Underwriters' Laboratory Class A Fire Rating (Building Materials Directory, File #R7910) when used in either of the following constructions:
  - Limited to noncombustible decks at inclines not exceeding ¼ in. (6 mm) to the horizontal 1 ft (0.3 m). One layer of Bituthene waterproofing membrane, followed by one layer of ⅛ in. (3 mm) protection board, encased in 2 in. (50 mm) minimum concrete monolithic pour.
  - Limited to noncombustible decks at inclines not exceeding ¼ in. (6 mm) to the horizontal 1 ft (0.3 m). One layer of Bituthene waterproofing membrane, followed by one layer of DOW Styrofoam PD Insulation Board [2 in. (50 mm) thick]. This is covered with one layer of 2 ft x 2 ft x 2 in. (0.6 m x 0.6 m x 50 mm) of concrete paver topping.

## Warranty

Five year material warranties covering Bituthene and Hydroduct products are available upon request. Contact your Grace sales representative for details.

## Technical Services

Support is provided by full time, technically trained Grace representatives and technical service personnel, backed by a central research and development staff.

## Supply

|  |  |
|--|--|
| <b>Bituthene System 4000</b>           | 3 ft x 66.7 ft roll (200 ft <sup>2</sup> ) [0.9 m x 20 m (18.6 m <sup>2</sup> )]     |
| Roll weight                            | 83 lbs (38 kg) gross   |
| Palletization                          | 25 rolls per pallet  |
| Storage                                | Store upright in dry conditions below 95°F (+35°C).                                  |
| <b>System 4000 Surface Conditioner</b> | 1 x 0.625 gal (2.3 L) bottle in each roll of System 4000 Membrane                    |
| <b>Ancillary Products</b>              |  |
| Surface Conditioner Sprayer            | 2 gal (7.6 L) capacity professional grade sprayer with specially engineered nozzle   |
| Bituthene Liquid Membrane              | 1.5 gal (5.7 L) pail/125 pails per pallet or 4 gal (15.1 L) pail/48 pails per pallet |
| Hydroduct Tape                         | 1 in. x 200 ft (2.5 cm x 61.0 m) roll/6 rolls per carton                             |
| Bituthene Mastic                       | Twelve 30 oz (0.9 L) tubes/carton or 5 gal (18.9 L) pail/36 pails per pallet         |
| <b>Complementary Material</b>          |  |
| Hydroduct                              | See separate data sheets   |

**Equipment by others:** Soft broom, utility knife, brush or roller for priming

## Physical Properties for Bituthene 4000 Membrane

| Property   | Typical Value                                  | Test Method                       |
|--|--|-----------------------------------|
| Color  | Dark gray-black                                |                                   |
| Thickness  | 1/16 in. (1.5 mm) nominal                      | ASTM D3767—method A               |
| Flexibility, 180° bend over 1 in. (25 mm) mandrel at -25°F (-32°C) | Unaffected                                     | ASTM D1970                        |
| Tensile strength, membrane, die C                                  | 325 lbs/in. <sup>2</sup> (2240 kPa) minimum    | ASTM D412 modified <sup>1</sup>   |
| Tensile strength, film   | 5,000 lbs/in. <sup>2</sup> (34.5 MPa) minimum  | ASTM D882 modified <sup>1</sup>   |
| Elongation, ultimate failure of rubberized asphalt                 | 300% minimum                                   | ASTM D412 modified <sup>1</sup>   |
| Crack cycling at -25°F (-32°C), 100 cycles                         | Unaffected                                     | ASTM C836                         |
| Lap adhesion at minimum application temperature                    | 5 lbs/in. (880 N/m)                            | ASTM D1876 modified <sup>2</sup>  |
| Peel strength  | 9 lbs/in. (1576 N/m)                           | ASTM D903 modified <sup>3</sup>   |
| Puncture resistance, membrane                                      | 50 lbs (222 N) minimum                         | ASTM E154                         |
| Resistance to hydrostatic head                                     | 210 ft (70 m) of water                         | ASTM D5385                        |
| Permeance  | 0.05 perms (2.9 ng/m <sup>2</sup> sPa) maximum | ASTM E96, section 12—water method |
| Water absorption   | 0.1% maximum                                   | ASTM D570                         |

### Footnotes:

1. The test is run at a rate of 2 in. (50 mm) per minute.
2. The test is conducted 15 minutes after the lap is formed and run at a rate of 2 in. (50 mm) per minute at 40°F (5°C).
3. The 180° peel strength is run at a rate of 12 in. (300 mm) per minute.

## Physical Properties for System 4000 Surface Conditioner

| Property                     | Typical Value         |
|------------------------------|-----------------------|
| Solvent type                 | Water                 |
| Flash point                  | >140°F (>60°C)        |
| VOC* content                 | 91 g/L                |
| Application temperature      | 25°F (-4°C) and above |
| Freeze thaw stability        | 5 cycles (minimum)    |
| Freezing point (as packaged) | 14°F (-10°C)          |
| Dry time (hours)             | 1 hour**              |

\* Volatile Organic Compound

\*\* Dry time will vary with weather conditions

[www.graceconstruction.com](http://www.graceconstruction.com)

**For technical assistance call toll free at 866-333-3SBM (3726)**

Bituthene, Preprufe, Hydroduct and Ripcord are registered trademarks of W. R. Grace & Co.—Conn.

We hope the information here will be helpful. It is based on data and knowledge considered to be true and accurate and is offered for the users' consideration, investigation and verification, but we do not warrant the results to be obtained. Please read all statements, recommendations or suggestions in conjunction with our conditions of sale, which apply to all goods supplied by us. No statement, recommendation or suggestion is intended for any use which would infringe any patent or copyright. W. R. Grace & Co.—Conn., 62 Whittemore Avenue, Cambridge, MA 02140. In Canada, Grace Canada, Inc., 294 Clements Road, West, Ajax, Ontario, Canada L1S 3C6.

This product may be covered by patents or patents pending.  
BIT-220G Printed in U.S.A. 5/08

Copyright 2008. W. R. Grace & Co.—Conn.  
FA/LVI/1M

**GRACE**