

## BITUTHENE® MASTIC

One part, gun or trowel applied mastic for sealing Bituthene membrane terminations and details

### Description

Bituthene® Mastic is a rubberized, asphalt-based mastic. It has excellent adhesion to structural concrete, masonry and wood. The VOC (Volatile Organic Compound) content is 200 g/L.

Architectural and Industrial Maintenance Regulations limit the VOC content in products classified as Architectural Coatings. Refer to Technical Letters at [www.graceconstruction.com](http://www.graceconstruction.com) for most current list of allowable limits.

Bituthene Mastic is available in tubes or pails.

### Use

Bituthene Mastic is designed to seal terminations, edges of patches and overlaps in detail areas. On vertical applications, the mastic must be applied to both the top and bottom terminations.

### Product Advantages

- Excellent adhesion
- Seals terminations, edges of patches and overlaps in detail areas

### Limitation

Bituthene Mastic is an integral part of the Bituthene waterproofing system. This mastic should not be applied where it will be covered with Bituthene waterproofing membrane, except as permitted as a temporary cutoff. It should not be used as a primary waterproofing material.

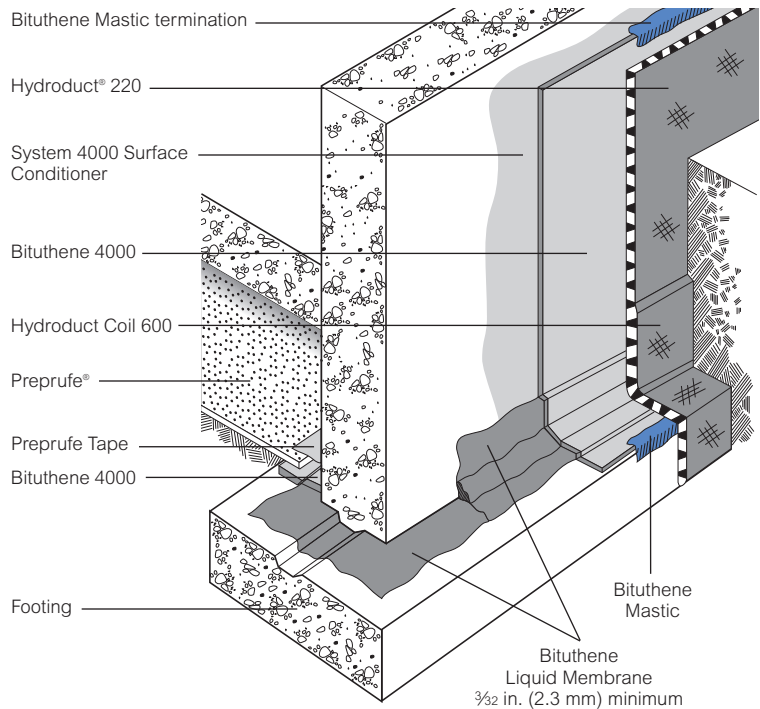

Drawings are for illustration purposes only. Please refer to [www.graceconstruction.com](http://www.graceconstruction.com) for specific application details.

## Supply

Bituthene Mastic		
Unit size	30 oz (.9 L) tube	5 gal (18.9 L) pail
Packaging	12 tubes/carton	36 pails/pallet
Weight	33 lbs (15 kg)/carton	54 lbs (24 kg)/pail
Coverage	1 tube—65 linear feet (20 m) [0.25 in. (6 mm) x 0.25 in. (6 mm) bead]	100 linear ft/gal (8.1 m/L) [1 in. (25 mm) wide troweling]

## Application Procedures

### Safety, Storage and Handling Information

Bituthene products must be handled properly. Vapors from solvent-based primers and mastic are harmful and flammable. For these products, the best available information on safe handling, storage, personal protection, health and environmental considerations has been gathered. Material Safety Data Sheets (MSDS) are available at [www.graceconstruction.com](http://www.graceconstruction.com) and users should acquaint themselves with this information. Carefully read detailed precaution statements on product labels and the MSDS before use.

### Application

Apply Bituthene Mastic either with a caulking gun or trowel. If applied with a caulking gun, level the bead with a trowel to about 0.125 in. (3 mm) thickness and 0.5 in. (13 mm) to 1 in. (25 mm) width. When applied as a temporary cutoff, trowel Bituthene Mastic to 0.060 in. (1.5 mm) thickness. Bituthene waterproofing membrane may be placed over the thin cutoff the next day.

On the bottom edge of vertical applications, Bituthene Mastic should be troweled upward. Use it liberally at membrane terminations.

Material usage requirements for Bituthene Mastic will vary widely from job to job. On large horizontal plaza areas with few protrusions, only about one quarter of a tube may be required per roll of membrane. A vertical application may require one half tube or more per roll of membrane. Applications involving other protrusions may require one or more tubes per roll.

Clean tools with mineral spirits at the end of each day. Mineral spirits is a combustible liquid and should be used only in accordance with the manufacturer's safety recommendations. Do not use solvents to clean hands or skin.

## [www.graceconstruction.com](http://www.graceconstruction.com)

Bituthene, Hydroduct and Preprufe are registered trademarks of W. R. Grace & Co.—Conn. We hope the information here will be helpful. It is based on data and knowledge considered to be true and accurate and is offered for the users' consideration, investigation and verification, but we do not warrant the results to be obtained. Please read all statements, recommendations or suggestions in conjunction with our conditions of sale, which apply to all goods supplied by us. No statement, recommendation or suggestion is intended for any use which would infringe any patent or copyright. W. R. Grace & Co.—Conn., 62 Whittemore Avenue, Cambridge, MA 02140. In Canada, Grace Canada, Inc., 294 Clements Road, West, Ajax, Ontario, Canada L1S 3C6.

This product may be covered by patents or patents pending.  
BIT-290D Printed in U.S.A. 3/07

Copyright 2007. W. R. Grace & Co.—Conn.  
FA/LI/1M

GRACE