

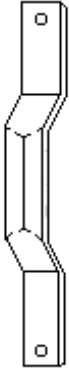

Masonry to Steel or Masonry to Masonry



Product Description

Dimension:

- Standard 12 gauge (plate) x 9" long

Finish:

- *Interior* (not in exposed with moisture)
Mill galvanized per ASTM A641/A641M (0.10 oz. per square foot)
- *Exterior* (or interior walls with a mean relative humidity exceeding 75%)
Hot dip galvanized after fabrication zinc coated per ASTM A153/A153M-B2
(1.50 oz per square foot).

Uses:

- Tying masonry to steel columns and beams
- Mechanically fastened or welded steel

Advantages:

- Simple and economical to install
- Allows steel to vibrate or move independently of masonry

For technical assistance call us toll free at 1-800-659-4731.