

PRODUCT SUBMITTAL

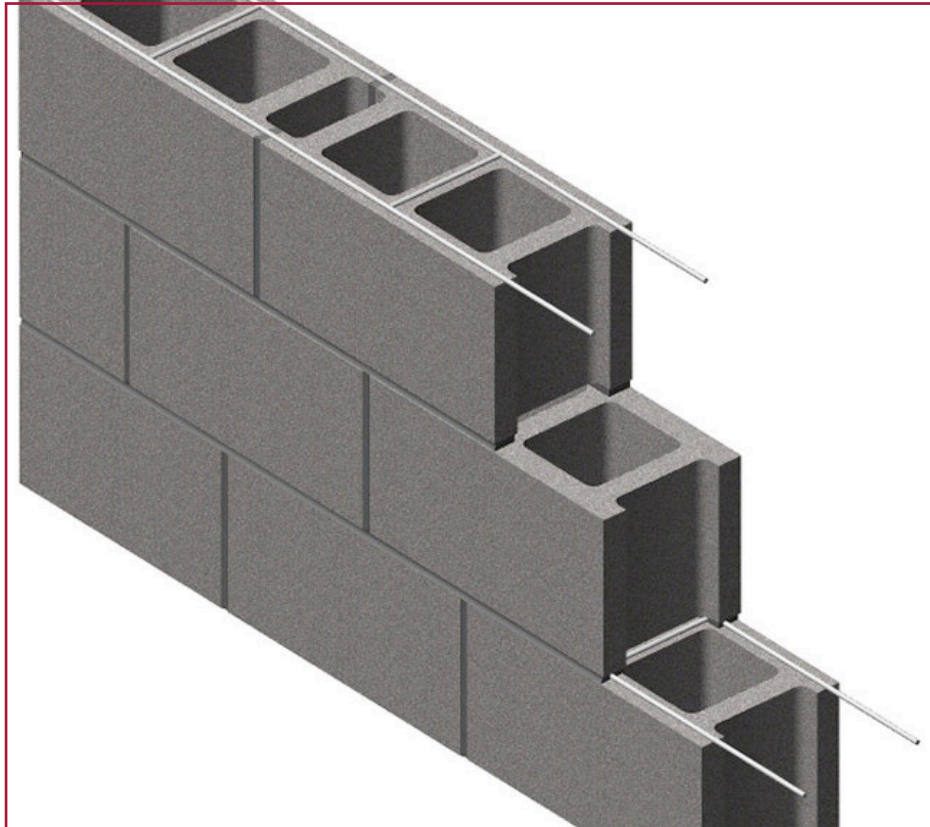

Series 200 Ladder Mesh (For Single Wyth Wall)



16" O.C. cross rods allow core clearance.

MATERIAL CONFORMANCE

ASTM A82 / A82M - (Cold drawn steel wire)
 Tensile Strength - 80,000 psi
 Yield Point - 70,000 psi
ASTM A951 / A951M-06 - (Standard Specification for Steel Wire for Masonry Joint Reinforcement)
ACI / ASCE 530 - (Building code requirements for masonry structures)
 Mill Galvanized / Zinc Coating: **ASTM A641 / A641M (0.10 Oz per sq ft)**
 Hot Dip Galvanized after fabrication / Zinc Coating
ASTM A153 / A153M-B2 (1.50 oz per sq ft)
 Stainless Steel **ASTM 580 / ASTM 580M Type 304** (Type 316 available on special order)

WIRE Recycled Content:

Mill Galvanized & Hot Dip,
 85% Post-Consumer
 13% Post Industrial / Pre - Consumer
 Stainless Steel,
 60% Post Consumer
 V O C Content - 0%



SIZES / FINISHES

- Mill Galvanized / Zinc Coating: **ASTM A641 / A641M (0.10 Oz per sq ft)**
- Hot Dip Galvanized after fabrication / Zinc Coating
ASTM A153 / A 153 - B2 (1.50 oz per sq ft)
- Stainless Steel **ASTM 580 / ASTM 580M Type 304** (Type 316 available on special order)

| | <u>Side Rods</u> | <u>Cross Rods</u> |
|---|-------------------|-------------------|
| <input type="checkbox"/> Standard | 9 Gauge (.148 in) | 9 Gauge |
| <input type="checkbox"/> Heavy Duty | 3/16" (.187 in) | 9 Gauge |
| <input type="checkbox"/> Extra Heavy Duty | 3/16" (.187 in) | 3/16" |



MASONPRO, Inc.
 Northville, MI 48167
 1-800-659-4731
 www.masonpro.com