

Ladder Hook & Eye

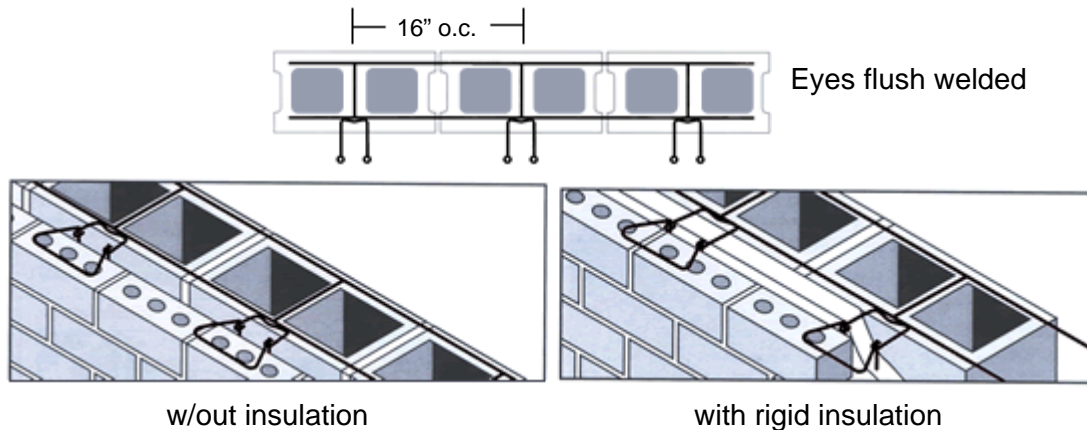

Multi-Wythe Core Clear Adjustable Reinforcement



Product Description

Dimension:

- Standard 9 gauge (.148 in) side rods and 9 gauge (.148 in) cross rods. Cross rods spaced 16" oc for optimum CMU core clearance.

Finish:

- *Exterior* (or *interior* walls with a mean relative humidity exceeding 75%) hot dip galvanized after fabrication zinc coated per ASTM A153/A153M-B2 (1.50 oz per square foot)

Use:

- Multi-Wythe composite and cavity wall applications.

Advantages:

- Eye sections flush welded to the face of the longitudinal side rods at the intersection of the cross rods provides a thinner wire profile, greatly improving the workability and quality control by the mason
- 16" oc ladder design positions cross rods on webs of CMU maximizing core clearance
- Improves rebar centering utilizing full strength of grout
- Eliminates cross rod restrictions for flow of grout or loose fill insulation and minimizes air pockets
- Reduces labor by simplifying installation of rebar, grout and loose fill insulation
- Improves resistance to shrinkage cracking with interlocking "T's" formed 16" oc at the intersections of cross & side rods centered on the webs of the CMU

For technical assistance call us toll free at 1-800-659-4731.