

# PRODUCT SUBMITTAL

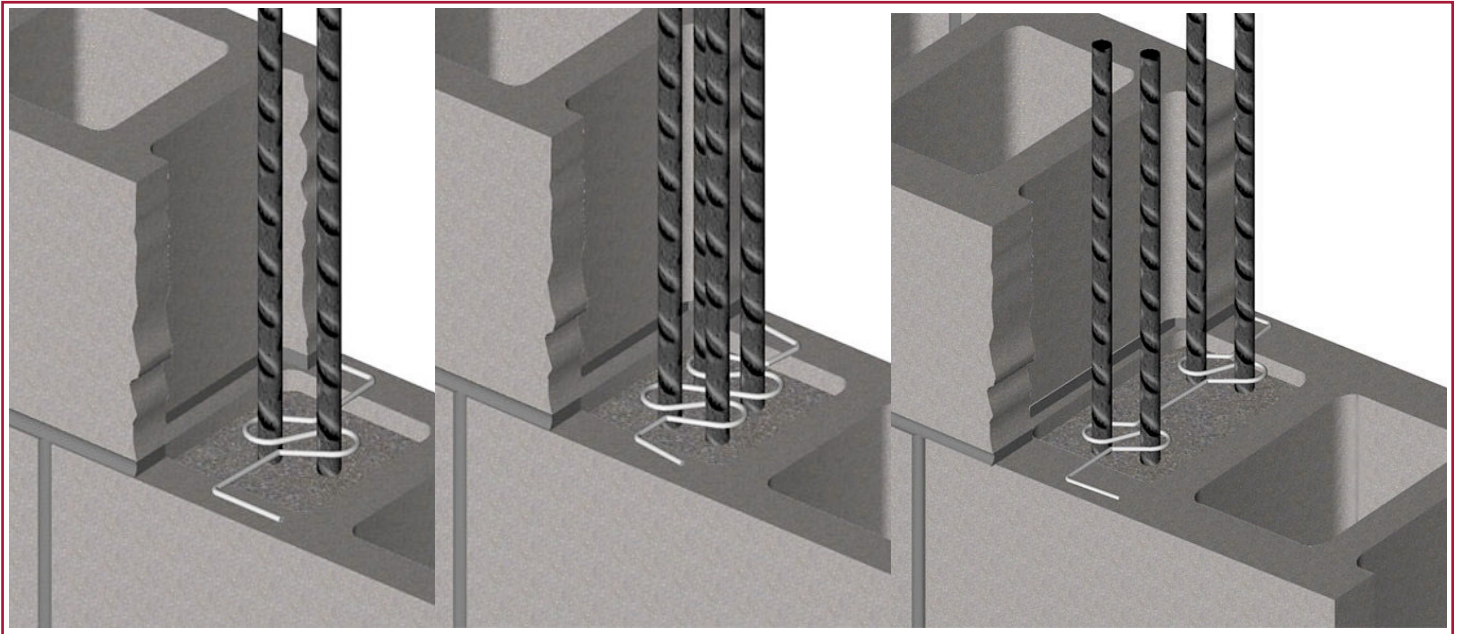

## Rebar Positioners Figure 8



# 3404  
Single for  
8" CMU

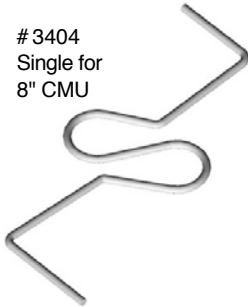

# 3404  
Double for  
8" CMU

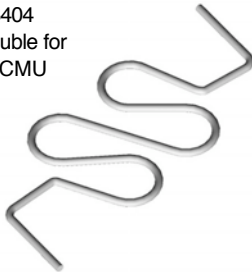

# 3404  
Double for  
12" CMU

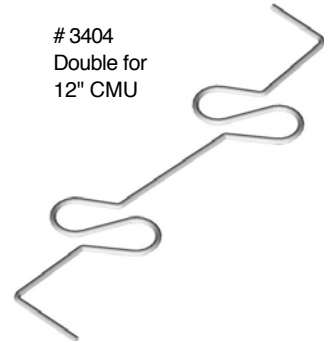

All positioners accept up to # 8 rebar

### MATERIAL CONFORMANCE

**Wire (Carbon Steel):** Prefabricated from cold-drawn steel wire conforming to **ASTM A1064/A1064M, ASTM A82 / A82M**  
Tensile Strength - 80,000 psi  
Yield Point - 70,000 psi

Mill Galvanized / Zinc Coating: **ASTM A641 / A641M (0.10 Oz per sq ft)**

Hot Dip Galvanized after fabrication / Zinc Coating  
**ASTM A153 / A153M-B2 (1.50 oz per sq ft)**

Stainless Steel (WIRE) **ASTM A580 / ASTM A580M**  
Stainless Steel ( SHEET METAL) **ASTM A167 Type 304**  
(Type 316 available on special order)

#### Recycled Content:

Mill Galvanized & Hot Dip,  
82.8% Post-Consumer  
17% Post Industrial / Pre - Consumer  
Stainless Steel,  
60% Post Consumer  
V O C Content - 0%



### DESCRIPTION / SIZES / FINISHES

#### DESCRIPTION:

Controls location of rebar, avoiding the edges of the cores of the blocks.  
Accepts up to # 8 rebar

#### GAUGES:

9 GAUGE

#### SIZES FOR CMU:

6" Single    8" Single    8" Double    10" Single    10" Double  
 12" Single    12" Double

#### FINISH:

Mill Galvanized    Hot Dip Galvanized



[www.wirebond.com](http://www.wirebond.com)

MASONPRO, Inc.  
43300 Seven Mile Road  
Northville, MI 48167  
1-800-659-4731  
[www.masonpro.com](http://www.masonpro.com)