

# FIELD NOTE

## Installation of Cavity Wall Insulation (Adhere to Substrate)

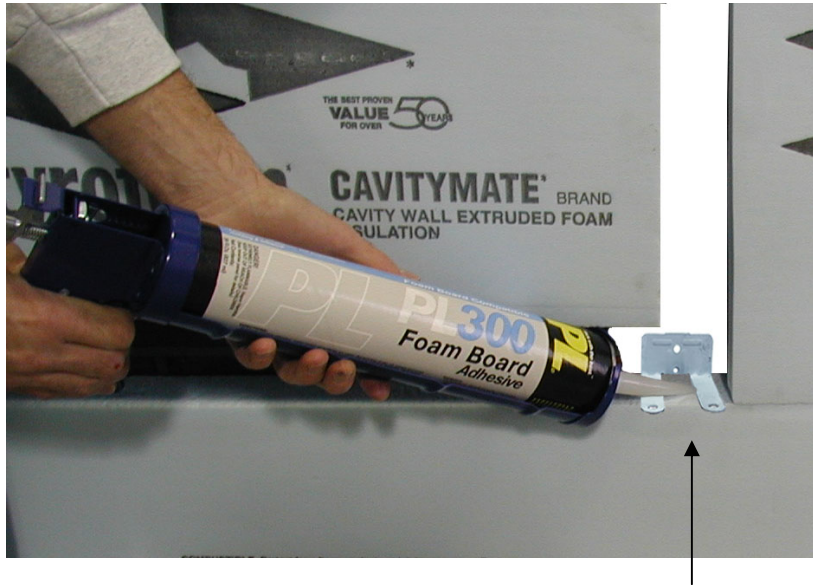

Apply ¼" diameter bead of PL300 adhesive over the adjust. brick ties or wire ties to adhere the insulation to the ties which in turn are mechanically attached to the substrate.

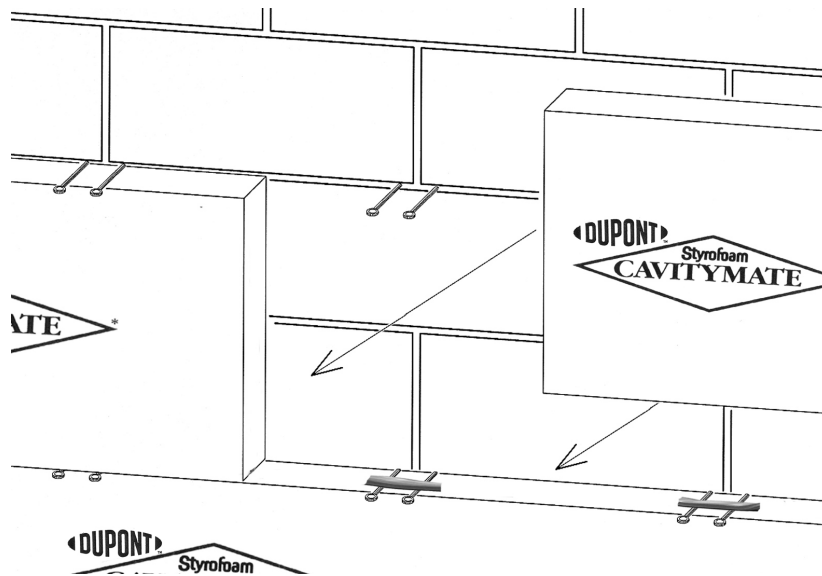

**MASONPRO®**

1-800-659-4731

[sales@masonpro.com](mailto:sales@masonpro.com)

[www.masonpro.com](http://www.masonpro.com)